

LEAD IN WATER RE-TEST REPORT
Gaston Elementary School
300 Park Street
Gaston, Oregon 97119

EIS Job No. 2021043. Gaston Elementary School Building LIW Re-test

Prepared For:

C/O Bryan VanDyke, Facilities Director
Gaston SD 511J
300 Park street
Gaston, Oregon 97119

Prepared By:

Environmental Inspection Services
11981 Fargo Road
Aurora, Oregon 97002
cell # (503) 680-6398
EMAIL: charles_a_spear@yahoo.com

Charles A. Spear

Charles A. Spear, Partner
Environmental Professional

June 8, 2021



EIS
ENVIRONMENTAL INSPECTION SERVICES



June 8, 2021

EIS Job No.2021043.Gaston Elementary School LIW re-test report

C/O Bryan VanDyke, Facilities Director
Gaston SD 511J
300 Park street
Gaston, Oregon 97119

Reference: Lead in water (LIW)re-testing of the Gaston Elementary
School Building located at 300 Park Street in
Gaston, Oregon 97119

Dear Mr. Bryan VanDyke;

Environmental Inspection Services conducted a focused lead in water (LIW)retest episode the subject Gaston Elementary School Building located at 300 Park Street in Gaston, Oregon on Tuesday, May 11, 2021. A total of eleven (11) discreet water samples (No.s 2-12) were collected from various original tested points of consumption in the building. **This re-test episode was conducted in order to determine the existing LIW results from the original April, 2021 elevated LIW test locations. The lead action level of ten (10) percent tap water samples collected was not exceeded during this May, 2021 lead in water re-testing episode according to the requirements as stated in OAR 333-061-0030.**

The eleven (11) LIW retest sample analytical test results are summarized as follows:

SAMPLE NO.	SAMPLE LOCATION	ANALYTICAL TEST RESULT (LEAD)
11940100-002DW21B	Room # 8, x1271	ND
11940100-003DW21B	multi-purpose room	124 ppb
11940100-004DW21B	Room # 4, x1275	ND
11940100-005BF21B	staff restroom	ND
11940100-006CF21B	Room#11, x1272	1 ppb
11940100-007DW21B	Room#11, x1272	ND
11940100-008DW21B	Room #12, x1285	ND
11940100-009DW21B	Room #14, x1280	ND
11940100-010DW21B	Room #15, x 1260	ND
11940100-011DW21B	Room#19, x1276	7 ppb
11940100-012DW21B	Room#18, x1282	4 ppb

The LIW test results indicate one (1) elevated sample identified as sample No. 3 collected from the elementary multi-purpose room on Tuesday, May 11, 2021. Mr. Van Dyke was initially contacted by Charles spear of EIS on Tuesday, June 8, 2021 regarding the elevated test result. It was determined that this fixture would be removed from operation and placarded "Not for Human Consumption" and either replaced or repaired as necessary at that time.

The EPA Maximum Contaminant Limit (MCL) for lead in Public drinking water Systems is 15 parts per billion (ppb). The EPA action limit of 15 parts per billion (ppb) was utilized as the action limit for the purposes of this water sampling and testing episode. Plastic and sterile 250 ml. bottles were utilized for the drinking water sample collection.

All water samples were shipped to an ORELAP certified laboratory known as Alexin Analytical Laboratory located at 13035 S.W. Pacific Highway in Tigard, Oregon. The samples were received by Alexin on Wednesday, May 12, 2021; reported to EIS on Friday, June 4, 2021; and issued laboratory work order No. 1132014 (Alexin accreditation No. OR100013). The sample concentrations varied between None detected (ND) to a single elevated test result of 124 parts per billion (ppb) collected from the multi-purpose room.

A unique sample location code was assigned for each drinking water outlet sample. The attached alpha numeric sequence code was assigned for each sample.

Example - The sampling code for sample No. 3 is as follows:
11940100-003DW21B

First eight digits - School district and building code
No. 003 - Sample number 3
DW - drinking water faucet
21B - year 21 and second round of testing - B

The above listed fixture with the LIW result at or exceeding 15 ppb must be immediately removed from service. This can be accomplished by either shutting off the water to the fixture, and/or bagging the fixture. The elevated fixtures may not be returned to service until it has been remediated and retested. The resultant fixture sample must show a lead level to be below the EPA action limit of 15 ppb.

In the opinion of EIS, significant progress has been achieved and one of eleven (11) samples analytical test results exceeded the EPA Action Limit of 15 parts per billion (ppb). In the opinion of EIS, the single elevated faucet fixture should be replaced with certified non-lead faucet fixtures and plumbing. Water should not be utilized for consumption from this "elevated" fixture until the fixture is listed are replaced and certified lead free. No other lead in water concentration considerations were noted for the remaining ten (10) samples collected from throughout the Gaston Elementary School building.

Thank you for this opportunity to be of service. If there are questions concerning the lead in water analytical test results contact the Gaston School district at 1-503-985-0210.

Respectfully,
Charles A. Spear
Charles A. Spear, Partner
Environmental Inspection Services

APPENDIX 1.0
LEAD ANALYTICAL TEST RESULTS



**Professional
Laboratory
Services**

13035 SW Pacific Hwy
Tigard, OR 97223
Tel.: (503) 639-9311 Fax: (503) 684-1588

ANALYSIS REPORT

Reported: 06/04/2021
Received: 05/12/2021
Sampled By: Charles Spear
Work Order: 1132014

C Environmental Inspection Services

L Attn: Charles Spear
I 11981 Fargo Rd
E Aurora OR, 97002
N Phone: (503) 680-6398
T

Project: Gaston Elementary
Project # : 2021043
Sample Type : Grab
PO # : 2021043

Sampling Location: Gaston Elementary School 300 Park Street Gaston, C

Lab Number

Lab Number	Code	Method	Result	Units	MRL	EPA MCL*	Analysis Date/ Time
1132014-01	Sample Name: 1194 0100- 002 DW 21 B F-046 Sampled: 5/11/21 15:15 Sample Composition: Raw Single						Matrix: Drinking Water
+Lead	1030	EPA 200.9	ND	ppb	1	15 ppb	06/03/21 16:05
1132014-02	Sample Name: 1194 0100- 003 DW 21 B F-047 Sampled: 5/11/21 15:15 Sample Composition: Raw Single						Matrix: Drinking Water
+Lead	1030	EPA 200.9	124	ppb	10	15 ppb	06/03/21 16:05 MCLE
1132014-03	Sample Name: 1194 0100- 004 DW 21 B F-041 Sampled: 5/11/21 15:15 Sample Composition: Raw Single						Matrix: Drinking Water
+Lead	1030	EPA 200.9	ND	ppb	1	15 ppb	06/03/21 16:05
1132014-04	Sample Name: 1194 0100- 005 BF 21 B F-042 Sampled: 5/11/21 15:15 Sample Composition: Raw Single						Matrix: Drinking Water
+Lead	1030	EPA 200.9	ND	ppb	1	15 ppb	06/03/21 16:05
1132014-05	Sample Name: 1194 0100- 006 CF 21 B F-055 Sampled: 5/11/21 15:15 Sample Composition: Raw Single						Matrix: Drinking Water
+Lead	1030	EPA 200.9	1	ppb	1	15 ppb	06/03/21 16:05
1132014-06	Sample Name: 1194 0100- 007 DW 21 B F-057 Sampled: 5/11/21 15:15 Sample Composition: Raw Single						Matrix: Drinking Water
+Lead	1030	EPA 200.9	ND	ppb	1	15 ppb	06/03/21 16:05
1132014-07	Sample Name: 1194 0100- 008 DW 21 B F-058 Sampled: 5/11/21 15:15 Sample Composition: Raw Single						Matrix: Drinking Water
+Lead	1030	EPA 200.9	ND	ppb	1	15 ppb	06/03/21 16:05
1132014-08	Sample Name: 1194 0100- 009 DW 21 B F-059 Sampled: 5/11/21 15:15 Sample Composition: Raw Single						Matrix: Drinking Water
+Lead	1030	EPA 200.9	ND	ppb	1	15 ppb	06/03/21 16:05
1132014-09	Sample Name: 1194 0100- 010 DW 21 B F-062 Sampled: 5/11/21 15:15 Sample Composition: Raw Single						Matrix: Drinking Water
+Lead	1030	EPA 200.9	ND	ppb	1	15 ppb	06/03/21 16:05
1132014-10	Sample Name: 1194 0100- 011 DW 21 B F-063 Sampled: 5/11/21 15:15 Sample Composition: Raw Single						Matrix: Drinking Water
+Lead	1030	EPA 200.9	7	ppb	1	15 ppb	06/03/21 16:05



**Professional
Laboratory
Services**

13035 SW Pacific Hwy
Tigard, OR 97223
Tel.: (503) 639-9311 Fax: (503) 684-1588

ANALYSIS REPORT

Reported: 06/04/2021
Received: 05/12/2021
Sampled By: Charles Spear
Work Order: 1132013

**C
L
I
E
N
T** **Environmental Inspection Services**

Attn: Charles Spear
11981 Fargo Rd
Aurora OR, 97002
Phone: (503) 680-6398

Project:

Project # : 2021043
Sample Type : Grab
PO # : 2021043

Sampling Location: Gaston Elementary School 300 Park Street Gaston, C
Sample Matrix: Drinking Water

Lab Number

Lab Number	Code	Method	Result	Units	MRL	EPA MCL*	Analysis Date/ Time
1132013-01	Sample Name: 1194 0100- 012 DW 21 B						Matrix: Drinking Water
	Sampled: 5/11/21 15:45 Sample Composition: Raw Single						
+Lead	1030	EPA 200.9	4	ppb	1	15 ppb	06/03/21 16:05

ND = None detected at the MRL MRL = Minimum Reporting Limit MCL = Maximum Contamination Limit
†All procedures for this analysis are in accordance with NELAP standards.

* The EPA MCL for Lead in Public Drinking Water Systems is 15 ppb; this is a maximum contamination level for lead in samples, this is not an acceptance level for health based exposure.

Note: Please make sure to send your results to the appropriate agency; Alexin Analytical does not forward these results to any program or person other than the above listed client. It is your responsibility to make sure these results get sent to whichever agency, city, or organization has requested them if these results are for compliance purposes.

Approved by:

Adriana Gonzalez-Gray
Laboratory Director

This report shall not be reproduced, except in full, without the written approval of the laboratory.



**Professional
Laboratory
Services**

13035 SW Pacific Hwy
Tigard, OR 97223
Tel.: (503) 639-9311 Fax: (503) 684-1588

ANALYSIS REPORT

Reported: 06/04/2021
Received: 05/12/2021
Sampled By: Charles Spear
Work Order: 1132014

**C
L
I
E
N
T** **Environmental Inspection Services**

Attn: Charles Spear
11981 Fargo Rd
Aurora OR, 97002
Phone: (503) 680-6398

Project: Gaston Elementary
Project # : 2021043
Sample Type : Grab
PO # : 2021043

Sampling Location: Gaston Elementary School 300 Park Street Gaston, C

Lab Number

MCL This analyte exceeds the MCL limit.

ND = None detected at the MRL **MRL** = Minimum Reporting Limit

†All procedures for this analysis are in accordance with NELAP standards.

MCL = Maximum Contamination Limit

* The EPA MCL for Lead in Public Drinking Water Systems is 15 ppb; this is a maximum contamination level for lead in samples, this is not an acceptance level for health based exposure.

Note: Please make sure to send your results to the appropriate agency; Alexin Analytical does not forward these results to any program or person other than the above listed client. It is your responsibility to make sure these results get sent to whichever agency, city, or organization has requested them if these results are for compliance purposes.

Approved by:

Adriana Gonzalez-Gray
Laboratory Director

This report shall not be reproduced, except in full, without the written approval of the laboratory.

APPENDIX 2.0
CHAIN'S OF CUSTODY (COC'S)



Professional
Laboratory
Services

13035 SW Pacific Hwy Tigard, OR 97223 ph: 503.639.9311 fax: 503.684.1588 email: mail@alexinlabs.com

Chain of Custody Record

Laboratory Job Number:

Page 1 of 2

Client Contact Information		Results Reporting Information		Invoicing Information	
Company/Client Name:	GIS	Project Manager:		Accounts Payable Contact:	
Address:	11981 Fargo Road	Mailing Address:		Mailing Address:	
City/State/Zip:	Astoria, Oregon 97102	City/State/Zip:		City/State/Zip:	
phone:	503-680-6398	phone:		phone:	
fax or email:	charles@alexinlabs.com	fax or email:		fax or email:	

SAMPLING INFORMATION		P.O. #: 2002 013		PWSID #:	
Sampling Location:	Gaston Elementary School	Project Name:	Gaston Elementary	Project #:	
Sampled By:	Charles A. Spear	Send results to OR State Health Division? (Please circle)	Yes (No)	Permit #:	

Lab ID	Sample Identification	Please enter a unique ID per line for each separate sample	Date Collected	Time Collected	Sample Matrix*	# of con't rec'd	Analysis Requested**	SEE ATTACHED	Sample Specific Notes/Field Data for each WW sample, specify <u>Grab</u> / <u>Composite</u> for each DW sample, specify <u>Raw</u> / <u>Treated</u> , <u>Source</u> / <u>Distribution</u> , <u>Single</u> / <u>Combined</u> WHERE APPLICABLE
11940100-002	DW 21 B		5/11/21	3:15 pm	DW	1			grab/raw/single/composite
11940100-003	DW 21 B					1			
11940100-004	DW 21 B					1			
11940100-005	BF 21 B					1			
11940100-006	CF 21 B					1			
11940100-007	DW 21 B					1			
11940100-008	PW 21 B					1			
11940100-009	DW 21 B					1			
11940100-010	DW 21 B					1			
11940100-011	DW 21 B					1			
Relinquished By (print):	Charles Spear	Company:	ETS	Date/Time:	5/12/21	Received By:	Charles Spear	Company:	ETS
Relinquished By (print):	Charles Spear	Company:	ETS	Date/Time:	5/12/21	Received By:	Charles Spear	Company:	ETS
he most current revision of SOP-10-003 was used when these samples were collected <input type="checkbox"/>									
Drinking water (DW), effluent (EFF), ground water (GW), influent (INF), non-aqueous liquid (NAL), paint chips, raw water (RW), ludge, soil, solid, source water (SOURCE), spring, stormwater (SW), surface water, wastewater (WW), well water (WELL).									
** Analyses for SOC, Radionuclide, Radon, and Asbestos are subcontracted out to other accredited laboratories.									

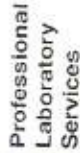

ph: 503.639.9311 fax: 503.684.1588 email: mail@alexinlabs.com

Laboratory Job Number:

Page 2 of 2

SAMPLING INFORMATION	
Sampling Location:	Gaston Elementary School
Sampled By:	Charles A. [Signature]
Project Name:	Project #:
P.O. #:	2021043
PWSID #:	Permit #:
Send results to OR State Health Division? (Please circle) Yes / No	

[illegible]

** Analyses for SOC, Radionuclide, Radon, and Asbestos are subcontracted out to other accredited laboratories.

APPENDIX 3.0
SCHOOL SAMPLING FLOOR PLAN

Gaston Elementary Evacuation Routes

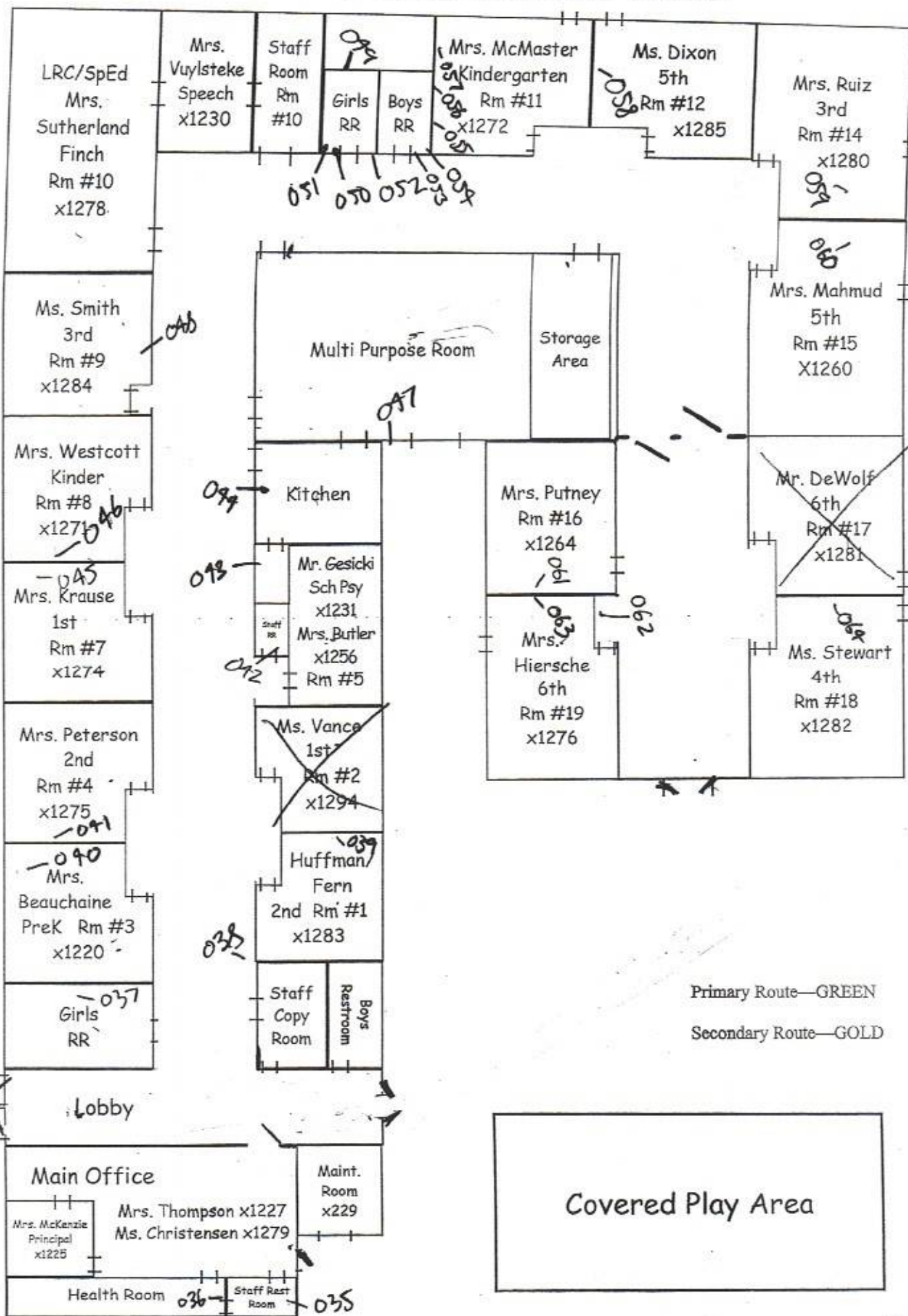

Front Playground SECONDARY ASSEMBLY AREA